

Clifford Road

[With thanks to **Sandra & John Haddon of Rosecroft , Lyndon Road .**]

Prior to the building of the Council Estate [and , of course , the Tay Homes Estate] , much of the land bordered by Clifford Road , Wetherby Road , the A1 and up to the Clifford boundary at Gipsy Lane was divided between two farms :

---- the fields nearer Bramham centre and Wetherby Road farmed from Milnthorpe Farm [the Old Royal Oak Inn] ; these were covered in the first phases of the Council Estate building [see sketch 1] .

---- the fields nearer Clifford , including Gallow Hill , farmed from Hilldrop Farm [now Hilldrop House in the village] ; these formed the plot for the completion of the Council Estate , the bungalows on Lyndon Road and , much later, TayHomes.

This second farmland was , at the time of the 1817 Map , in the ownership of Bramham Old Hall . In 1851 Hilldrop was the home of **Thomas [44] & Ann [40] Powell** , one of whose children was Walter [3] .

By 1881 Hilldrop was the farmhouse of **Walter Powell [33]** who was farming 120 acres in the parish , including these fields of arable meadows and pasture land along Clifford Road as yet owned by Bramham Old Hall :

The two Birkland Closes , Gallow Hill Close , Middle Gallow Hill Close and Far Gallow Hill Close , comprising 29 acres ; and

Bur Tree Close and Little Fields , comprising 10 acres.

These fields occupied the area shown in black on sketch 2 .

In 1900 the owner of Bramham Old Hall , Rev. Joseph Powell Metcalfe of Bilborough , left his estate , including these 39 acres , to his three children :

Rev. John Prideaux Metcalfe of Newbottle , Banbury

Rev. Humphrey Gostwyck Metcalfe of Kirby Wharfe , Tadcaster

Lucretia Elizabeth Eamonson Metcalfe

1918 saw the Metcalfe family sell the Old Hall Estate ; these 39 acres went to **George Jenkinson** of Hilldrop Farm , who was already farming them as a tenant , and whose father and forebears held Wise Warren Farm , Headley . The price Jenkinson paid was £1238 . 10 . 0 .

In January 1936 , George Jenkinson sold these lands for £ 1655 to **Percy Pemberton** , an accountant of Clifford [the Pembertons lived at Springfield House , then just over the Beck from Clifford Mill] .

In September 1941 , Percy Pemberton died , leaving his estate in the hands of executors Thomas Pemberton [company director] , Bertram Mortimer [accountant] , John Revis [corn merchant] and John Harry Bromley [solicitor] , the first of whom died in 1945 .

By March 1946 the remaining executors had sold this land for £ 2850 to the Roman Catholic Diocese of Leeds in two parcels :

the two fields nos. 118 & 119 of nearly 5 acres ; and
the larger part of the Gallow Hill plot of 34 acres.

The Church sold the smaller plot in July 1947 to Wetherby Rural District Council for £ 225 , and it was on this land that the final part of the Council Estate was built , along with the private bungalows , and later Tay Homes , along Lyndon Road. The Church have retained the larger plot comprising Gallow Hill and Gallow Hill Quarry ; this is still farmed by the Dawson family of Clifford.

N.B.1 The Clifford Road which , once past the school , winds up to Clifford has the name of Cabbage Hill . This originated from the market garden which the Robinson family ran there in the early C20 .

N.B. 2 The name Gipsy Lane 's origin would appear fairly obvious , and there are numerous tales of the gipsy families who lived in the area and were housed when the Council Estate was first built . It would be instructive to have these matters confirmed , and to see details of any gipsy encampments in Bramham .

SKETCH 1

1423 23 327

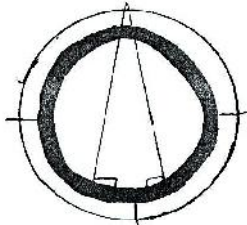
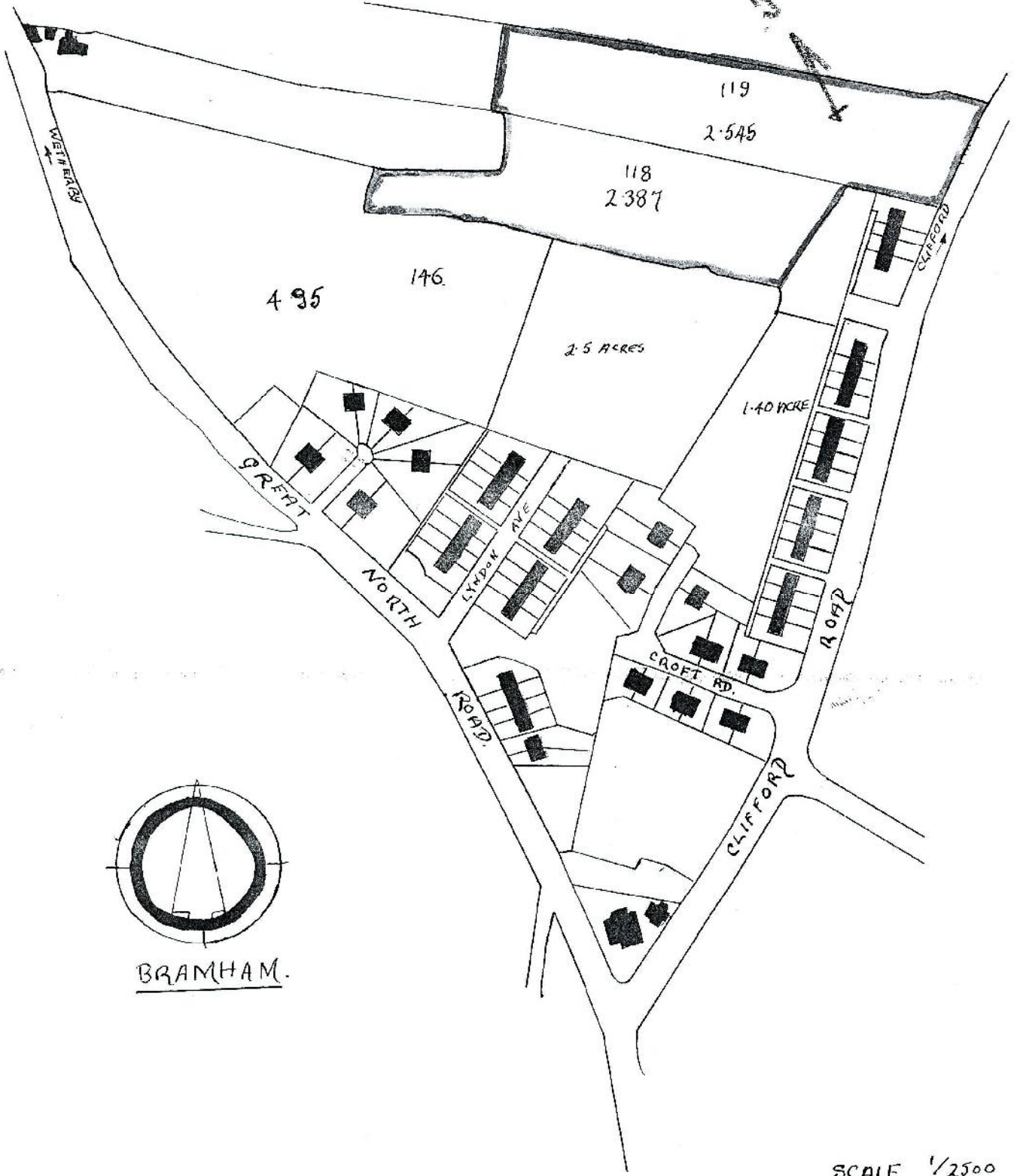

BRAMHAM.

SCALE 1/2500

SKETCH 2

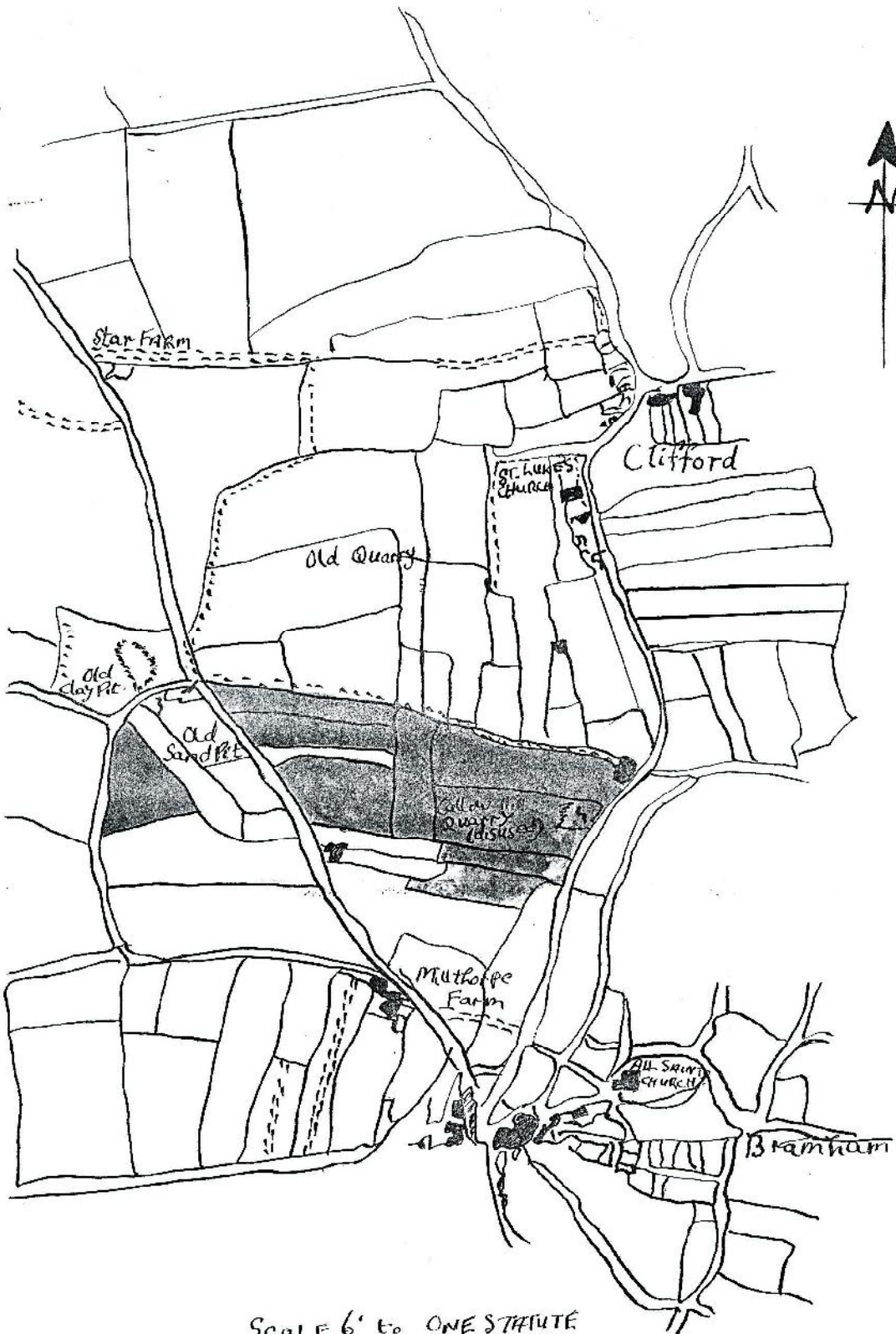

SCALE 6' TO ONE STATUTE MILE

SKETCH 3

PROPOSED OVERHEAD LINE SHEWEN THUS:—	
EXISTING " " " " " "	---
PROPOSED UNDERGROUND CABLE " " " " " "	--- ---
EXISTING " " " " " "	---
POLE/STEEL-MAST " " " " " "	--- ---
STAY " " " " " "	--- ---
PLAN No. W. 485	Ordnance Map No. 189-11
DATE	
Reproduced from, or based upon, the Ordnance Map with the Sanction of the Controller of H.M. Stationery Office. Crown Copyright Reserved.	

